



AUTOMA Declutchable Gear Operator - Series DG



- » Compact design, light weight
- » ISO 5211 top and bottom mounting
- » Easy switch from manual to pneumatic actuator
- » Special lubricant for internal parts
- » IP65 weatherproof
- » Output torque from 180Nm to 1300Nm
- » Five degree adjusting angle

MATERIALS:

Part No	Description	Material
1	Handwheel	Carbon steel
2	Shaft	Carbon steel
3	Pin	Stainless steel
4	Wrench	Carbon steel
5	Cap	Aluminium
6	Worm	Carbon steel
7	Worm gear	Ductile iron
8	Actuator shaft	Carbon steel
9	Body	Aluminium

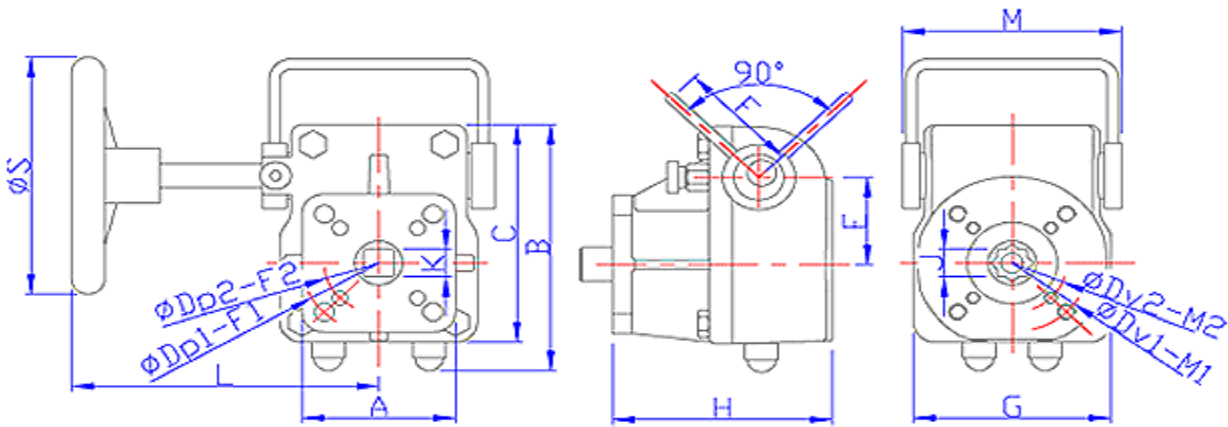
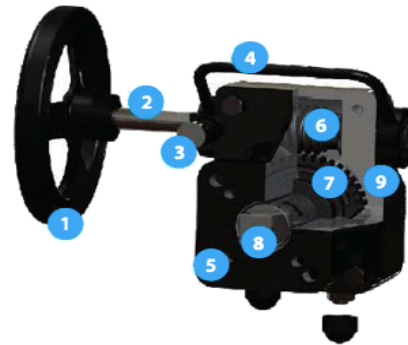

SPECIFICATIONS:

Model	Gear Ratio	Max. Output Torque (Nm)	Max. Input Torque (Nm)	Valve Connection	Valve Stem (mm)	Actuator Connection	Actuator Stem (mm)	Weight (kg)
DG 050	40:1	300	30	F05 / F07	11 / 14 / 17	F05 / F07	11 / 14 / 17	2.3
DG 070	38:1	360	30	F07 / F10	14 / 17 / 19	F07 / F10	14 / 17 / 19	3.5
DG 102	36:1	810	65	F10 / F12	22 / 27	F10 / F12	22 / 27	5.6
DG 140	50:1	1300	130	F12	27 / 36	F12	27 / 36	12.5

DIMENSIONS:

Model	A	B	C	E	F	Dp1	Dp2	M1	M2	K	G	H	L	M	S
DG 050	70	125	110	44	54	70	50	F07	F05	14	90	100	130	104	200
DG 070	95	150	135	52	70	102	70	F10	F07	17	125	118	150	124	200
DG 102	110	185	150	65	70	125	102	F12	F10	22	140	124	180	140	300
DG 140	140	230	210	85	78	125	-	F12	-	27	190	162	300	180	400